

ORIGINAL SPARE PARTS

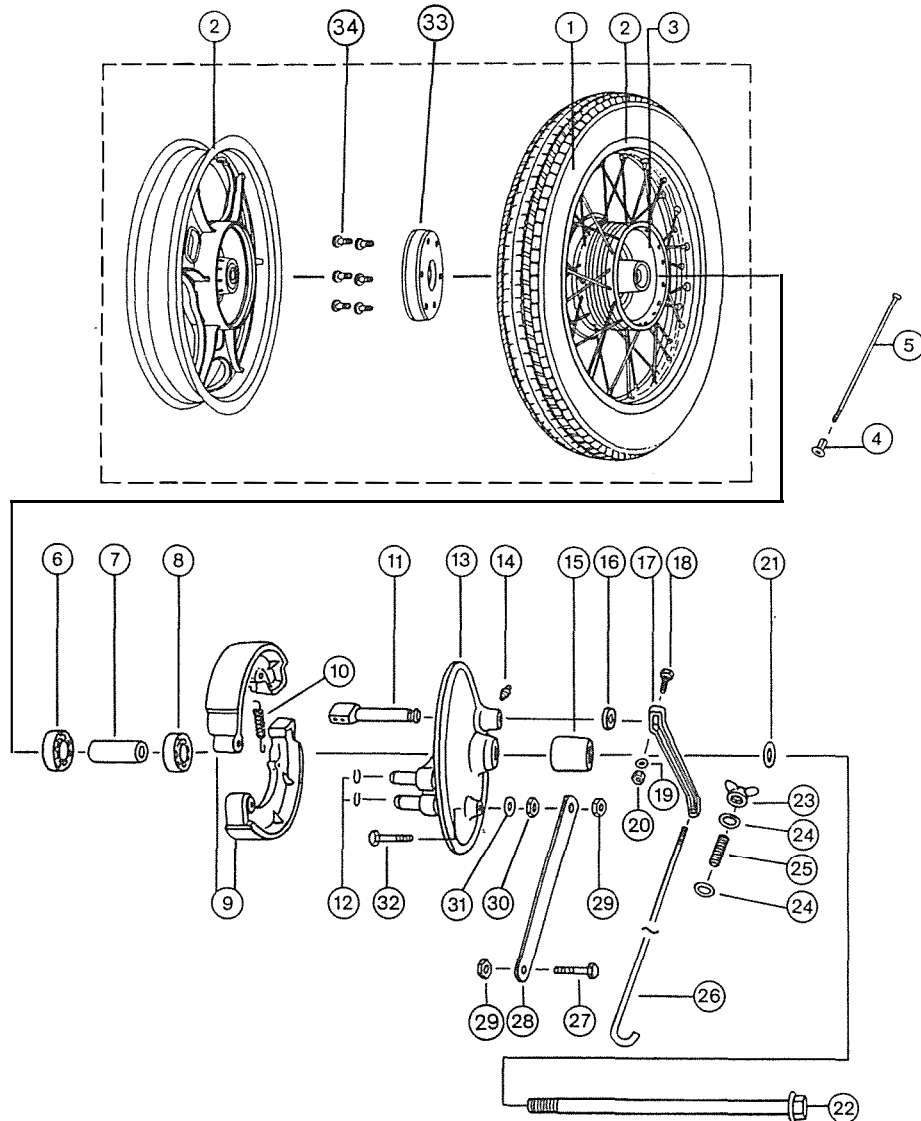

B 5

Bild Fig.	Teilnummer Part No.	Bezeichnung Description	Stück Qty.	Bemerkung Remarks					
				R	NR	VR	S	C	V
		2.11. Fahrgestell Hinterrad 2.11.Chassis Rear wheel							
1	93-37.333	Reifen 110/80-18 TGL 6498 Tyre 110/80-18 TGL 6498	1				x		
	93-37.336	Reifen 120/90-16 63P Tyre 120/90-16 63P	1						x
	96-37.327	Reifen 110/80-16, K36 Tyre 110/80-16 pattern K36	1	x	x	x			
	93-37.335	Reifen 120/90-16 TW 40 (Enduro) Tyre 120/90-16 TW 40 (Enduro)	1					x	
	96-39.956	Luftschlauch 3,25/3,50x16 TGL27252 Tube 3,25/3,50x16 TGL 27252	1	x	x	x	x	x	x
	96-40.154	Luftschlauch 3,25/3,50-18 TGL27252 Tube 3,25/3,50-18 TGL27252	1				x		
	96-41.901	Felgenband 29x16 TGL104-6 Flap 29x16 TGL 104-6	1		x	x		x	x
	30-24.063	Felgenband 18x31 Flap 29x16 TGL 104-6	1				x		
2	30-25.506	Hinterrad (Speichenrad) Rear wheel (Cast version)	1					x	x
	30-25.507	Hinterrad (Speichenrad) Rear wheel (spoke version)	1				x		
	91-55.183	Hinterrad (Gußrad) Rear wheel (Cast version)	1	x	x	x			
	30-25.762	Hinterrad (Speichenrad) Rear wheel (spoke version)	1		x	x			
	05-25.091	Tiefbettfelge 2.15x16 TGL12791-Lm Rim 2.15x16 TGL12791-Lm	1		x	x			
	30-25.530	Felge 16x2,50 DIN 7816 Rim 16x2,50 DIN 7816	1					x	x
	30-25.535	Felge 18x2,15 DIN 7816 TB Rim 18x2,15 DIN 7816 TB	1				x		
3	30-25.763	Hinterradnabe (vergl.Bild33 u.34) Rear wheel hub	1		x	x	x	x	x
4	93-71.287	Nippel M4 TGL 39-491 Nipple M4 TGL 39-491	36		x	x	x	x	x
5	93-71.326	Speiche A 121 TGL 39-491 Spoke A 121 TGL 39-491	36		x	x		x	x
	93-71.367	Speiche A 148 TGL 39-491 Spoke A 148 TGL 39-491	36				x		
6	93-94.236	Rillenkugellager DIN625-6302-2 Z Bearing DIN 625-6302-2 Z	2	x	x	x	x	x	x
7	80-50.702	Abstandshülse (Gußr.) (16x22x52,3) Dist.sleeve (Cast wheel) (16x22x52,3)	1	x	x	x			

34